

## VERNIER HOOK DEPTH GAGES

WITH MOUNTING HOLES FOR EXTENSION BASE

- Made of stainless steel
- Satin chrome plating finish on reading surface
- Optional accessory: extension base (code 6141)



1248-1501

extension base (optional)



6141 series

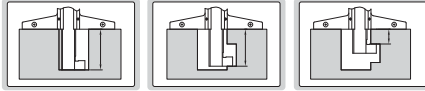

**Graduation 0.05mm (mm)**

Code	Range	Accuracy	L
1248-150	0-150mm	±0.05mm	266
1248-200	0-200mm	±0.05mm	316
1248-300	0-300mm	±0.08mm	416

**Graduation 0.02mm (mm)**

Code	Range	Accuracy	L
1248-1501	0-150mm	±0.03mm	266
1248-2001	0-200mm	±0.03mm	316
1248-3001	0-300mm	±0.04mm	416

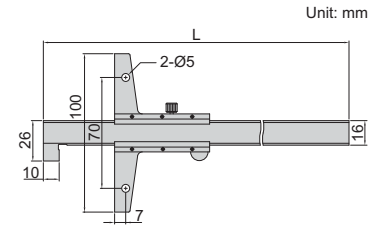

## VERNIER HOOK DEPTH GAGE

- Graduation 0.02mm
- Made of stainless steel
- Satin chrome plating finish on reading surface



1243-2001

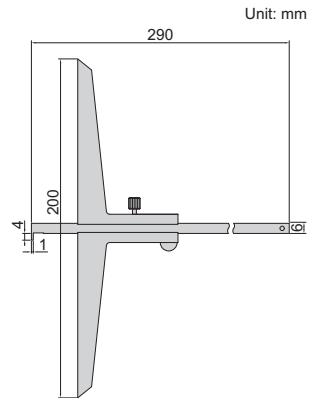

Code	Range	Accuracy
1243-2001	0-200mm	±0.03mm

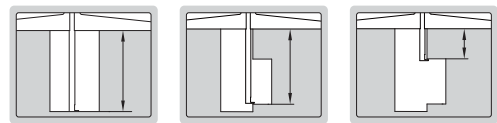

## EXTENSION BASES

- Supplied with two screws
- Made of stainless steel
- Suitable for depth gages series 1147, 1148, 1247, 1248 and 1249



6141-260

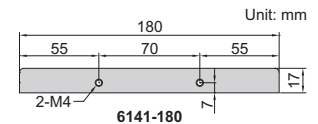

6141-180

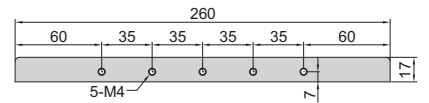

6141-260

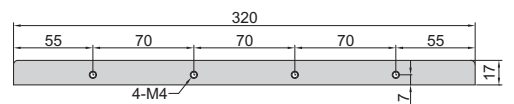

6141-320

Code	Length
6141-180	180mm
6141-260	260mm
6141-320	320mm

