

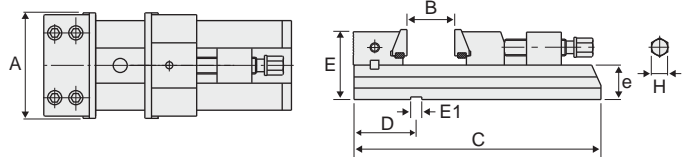

## V-40~47

**PRECISION RAPID VICE****Model: HG-100, 150(A,B,C,D), 200(A,B,C)**

- Designed with an instant clamping Hex-Nut for quick adjustment when clamping different work-pieces with irregular lengths.
- Movable Jaw can be easily moved for clamping etc.
- Jaws are slotted for increased grip on workpiece.
- Movable Jaw is short in length for maximum opening capacity.
- Tapered Jaws provide more stable clamping.
- Made entirely of steel the Vice is strong and powerful and retains accuracy.
- Compact design allows maximum workholding capacity on machine.



Unit: mm

**STANDARD ACCESSORIES:**

- 2 pcs of Alignment Wedge
- 4 pcs of Clamp

**SPECIFICATIONS** (Material: S50C, Hardness: HRC 58°~60°)

NO	Model	A	B	D	E	E1	e	C	H	Clamping force	Weight (kg)
V-40	HG-100	100	100	73 ± 0.02	68	14	37 ± 0.01	250	12	2T	8
V-41	HG-150A	150	150	88 ± 0.02	95	18	48 ± 0.01	350	23	4T	23
V-42	HG-150B		200					25			
V-43	HG-150C		250					27			
V-44	HG-150D		300					29			
V-45	HG-200A		200					55			
V-46	HG-200B	205	250	85 ± 0.02	126	18	63 ± 0.01	470	26	5T	63
V-47	HG-200C		300					73			



## V-48~54

**PRECISION RAPID VICE WITH SWIVEL BASE****Model: HG-150S(A,B,C,D), HG-200S(A,B,C)****STANDARD ACCESSORIES:**

- 2 pcs of Alignment Wedge
- 4 pcs of Clamp

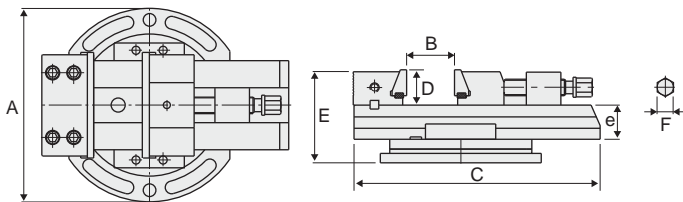

Unit: mm

**SPECIFICATIONS** (Material: S50C, Hardness: HRC 58°~60°)

NO	Model	A	B	D	E	e	C	F	Clamping force	Weight (kg)
V-48	HG-150SA	275	150	50	128	48 ± 0.01	350	23	4T	33
V-49	HG-150SB		200				35			
V-50	HG-150SC		250				37			
V-51	HG-150SD		300				39			
V-52	HG-200SA		200				65			
V-53	HG-200SB	350	250	69	163	63 ± 0.01	470	26	5T	73
V-54	HG-200SC		300				83			