

Estuche con aparato roscador, mango cilíndrico

Tapping head in box, cylindrical shank



Utilización: Para roscado rígido.

Sujeción del macho mediante pinza RUBBER-FLEX 70xx.ARN.xxx (\varnothing 2,8-7, \varnothing 7-13, \varnothing 9-16, \varnothing 16-23 mm.), y arrastre por el cuadrado del macho.

Suministro: Incluidas 2 pinzas y la llave.

Application: For tapping without compensation.

Tap clamping by RUBBER-FLEX 70xx.ARN.xxx (\varnothing 2,8-7, \varnothing 7-13, \varnothing 9-16, \varnothing 16-23 mm.), and driving by tap's square.

Delivery: Included 2 collets and wrench.

51xx.JAR

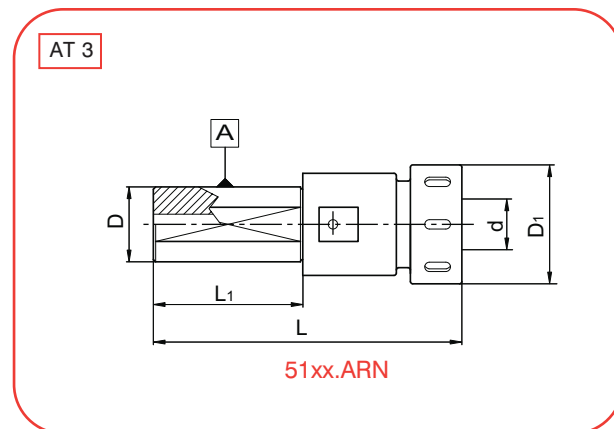

| D | COD | d | L | D1 | L1 |
|----|-------------|---------|-----|----|----|
| 25 | 5125.JAR.16 | M3-M16 | 110 | 42 | 60 |
| | 5132.JAR.30 | M10-M30 | 114 | 59 | 60 |

Piezas de recambio - Spare parts

| d | REF. | REF. | REF. | REF. | REF. | REF. | REF. |
|---------|----------------|---------|---------|----------|----------|--------|-------------|
| M3-M16 | 7016ARN100/160 | 74ARN16 | T908038 | CHD1608D | CHD1608I | LHWN16 | 51xx.ARN.16 |
| M10-M30 | 7030ARN200/300 | 74ARN30 | T910055 | CHD2010D | CHD2010I | LHWN25 | 51xx.ARN.30 |