

PATENTED
142711
M287204

V-27

SUPER OPEN QUICK ACTION VICE

Model: HSAC-160

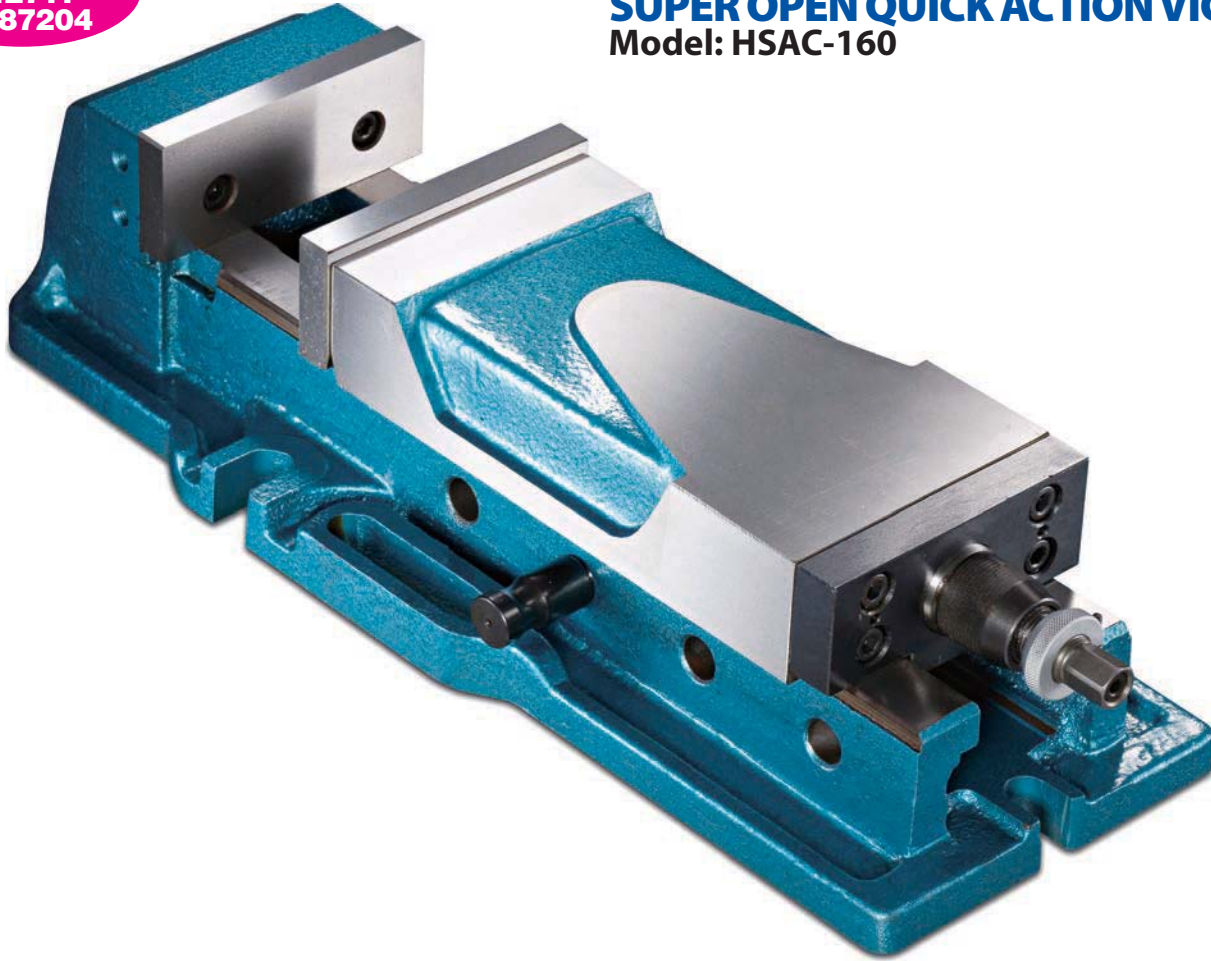

The patented MULTI-POWER SYSTEM built of **HIGH GRADE BEARING STEEL** provides extremely high clamping pressure. The pressure is more consistent and eliminates all leakage and maintenance problems associated with Hydraulic Vices.

- Patented **MULTI-POWER SYSTEM** provides extremely high clamping force of **0~4500kg**.
- No risk of loss of clamping pressure.
- No risk of oil leakage like Hydraulic Vices.
- More compact than Hydraulic Vices.
- Body has **ONE-PIECE CONSTRUCTION** for high rigidity and precision.
- **ANGLE-LOCK MECHANISM** provides downward pressure on Jaw to ensure parallel clamping.
- Both surfaces of Slideways are **HEAT TREATED**.
- Large opening capacity up to **300mm**.

DIMENSIONS

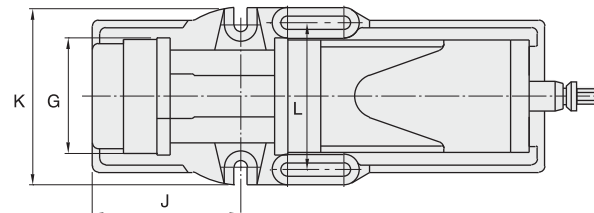
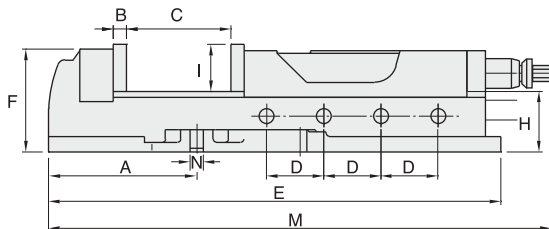

SPECIFICATIONS (Material: FCD 60 Ductile Iron. Hardness: HRC 50°)

Unit: mm

NO	Model	A	B	C	D	E	F	G	H	I	J	K	L	M	N	Weight (kg)
V-27	HSAC-160	200	15	300	77	610	139	158	82	63	200	240	190	915	18	58