



D-01

UNIVERSAL TILTING ROTARY TABLE

Model: HUT-300

- QUICK MANUAL INDEXING.
- Suitable for milling, boring, shaping, drilling, dividing, setting angles and for circular cutting.
- Tilting range of 90 degrees from horizontal to vertical position. For the tilting operation each turn of the handwheel tilts the table by 3 degrees and 5 minutes.
- 24 indexing holes around the edge of the table allow quick manual indexing.
- Graduations are large and clearly marked for quick and easy setting of complex angles.

OPTIONAL ACCESSORIES:

- Tail Stock
- Dividing Plate Set
- 7", 8" or 9" 3-Jaw Chuck

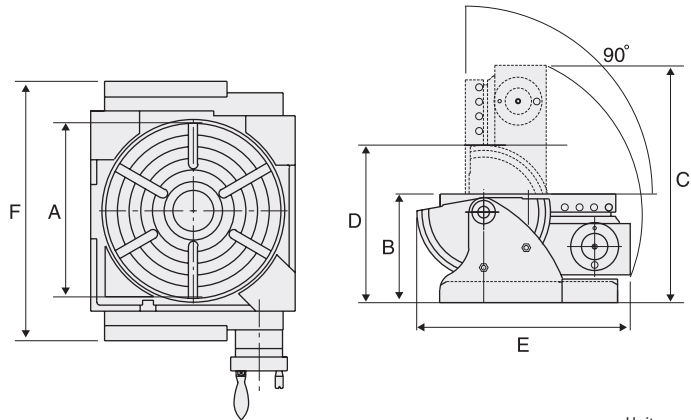

Unit: mm

SPECIFICATIONS

NO	Model	TABLE DIAMETER (A)	TABLE HEIGHT HORIZONTAL (B)	TABLE HEIGHT VERTICAL (C)	CENTER HEIGHT VERTICAL (D)	E	F	GEAR RATIO	CENTER HOLE	DIRECT INDEXING	Weight (kg)
D-01	HUT-300	∅300	185	405	228	336	444	90:1	MT-5	24-div.	93

D-02

Dividing Plate Set For HUT-300 Model: HUT-300DP

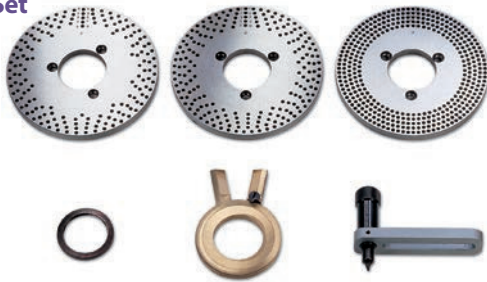

NUMBER OF HOLES:

- A Plate:** 9, 28, 34, 41, 47, 10, 29, 35, 43, 49
- B Plate:** 21, 31, 37, 44, 53, 26, 32, 38, 46, 59
- C Plate:** 61, 71, 77, 83, 91, 67, 73, 79, 89, 97

D-03

Tail Stock For HUT-300 Model: HUT-300TS

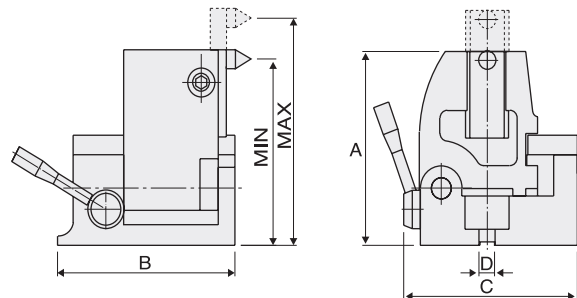

Unit: mm

SPECIFICATIONS

NO	Model	A	B	C	D	Center Height		Weight (kg)
						Max	Min	
D-03	HUT-300TS	200	196	190	16	230	113	23