

**PATENTED**  
142711  
M287204

V-28~29

## **MULTI-POWER FIXED ANGLE PRECISION VICE (EXTENDED TYPE)**

Model: HMAV-160, 200

The **SUPER-OPENING** design allows the jaws to open 310mm for HMAV-160 and 395mm for HMAV-200. With the Jaws mounted externally, the maximum work holding capacity is 450mm for HMAV-160 and 550mm for HMAV-200.

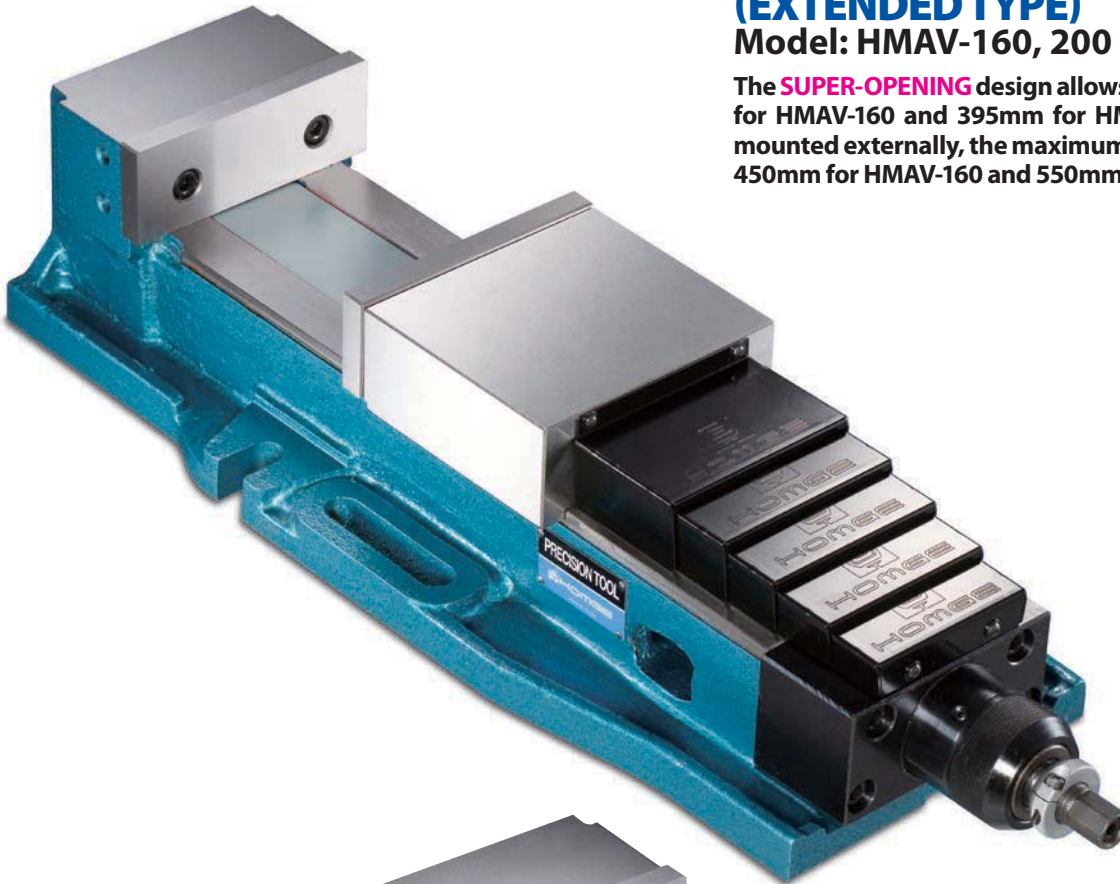

V-30~31

## **STANDARD FIXED ANGLE PRECISION VICE (EXTENDED TYPE)**

Model: HEAV-160, 200

This vice has the same features as model HMAV above but has standard clamping Leadscrew instead of the MULTI-POWER SYSTEM. The **SUPER-OPENING** design allows the jaws to open 340mm for HEAV-160 and 425mm for HEAV-200. With the Jaws mounted externally, the maximum work holding capacity is 480mm for HEAV-160 and 580mm for HEAV-200.

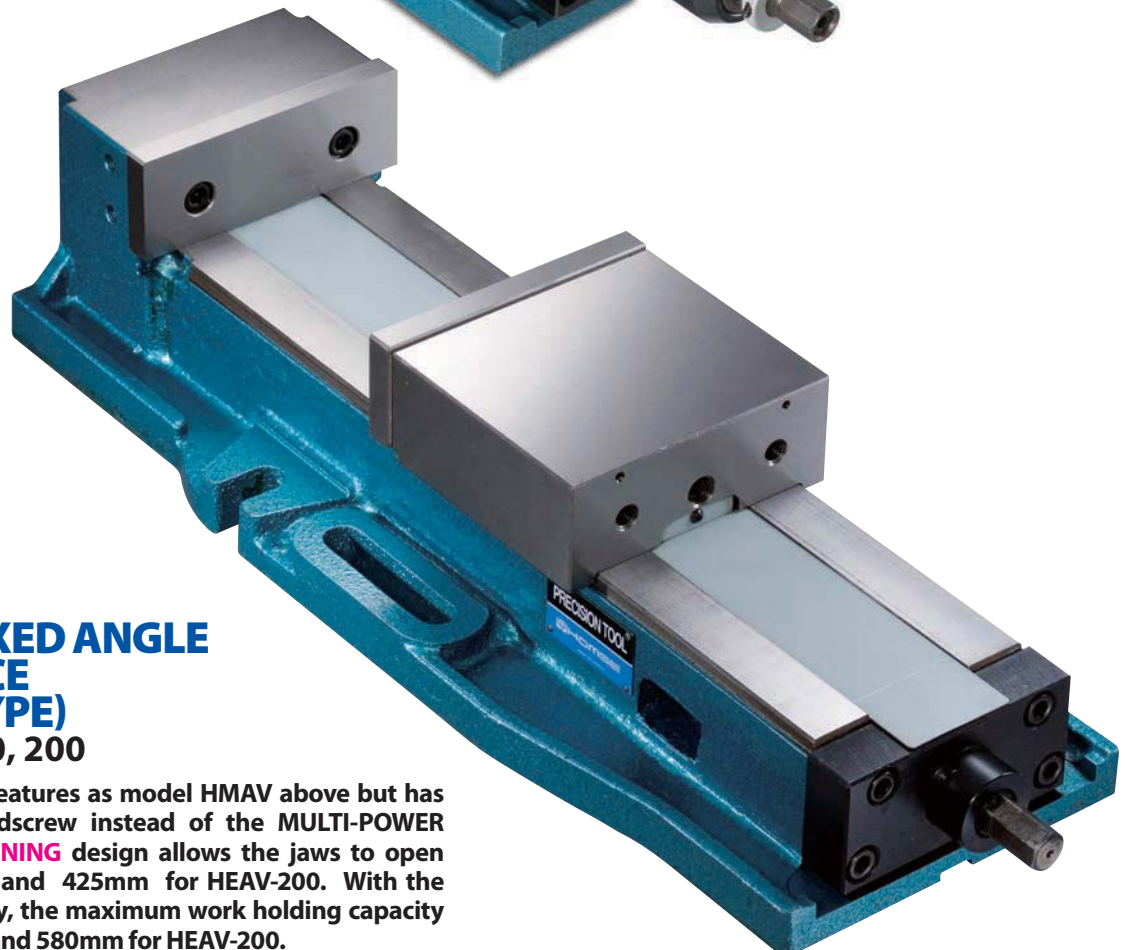

**1.** Equipped with **CHIP PROTECTION COVER**. Prevents chips getting into the vice and avoids any possible damage to internal parts.

**2.** Constructed of high grade materials with Slideways **HARDENED** to **HRC 50°** to ensure high accuracy and durability.

**3.** **ANGLE-LOCK MECHANISM** provides downward pressure on Jaw during clamping ensuring Jaws remain parallel and work is held accurately.

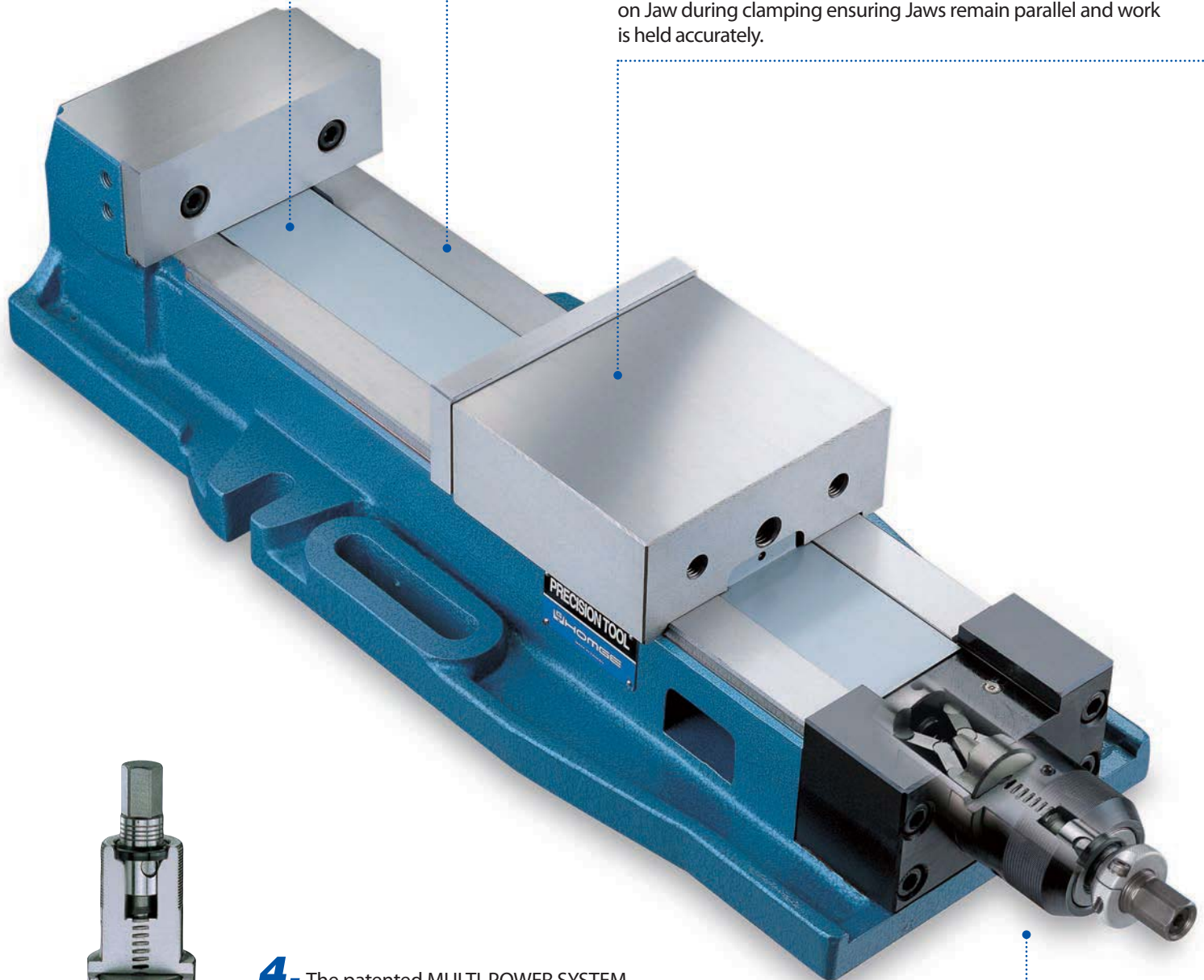

**4.** The patented **MULTI-POWER SYSTEM** built of **HIGH GRADE BEARING STEEL** provides extremely high clamping pressure. The pressure is more consistent and eliminates all leakage and maintenance problems associated with Hydraulic Vices.

**DIMENSIONS FOR 2 JAW PLATE POSITIONS**

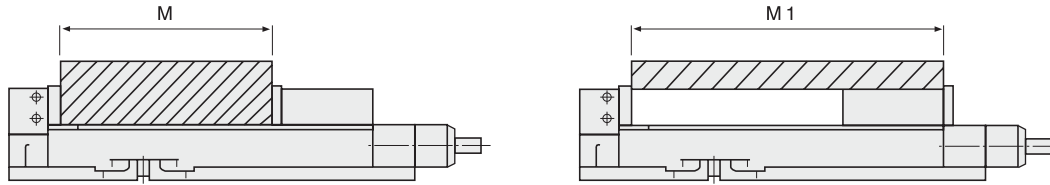

**DIMENSIONS**

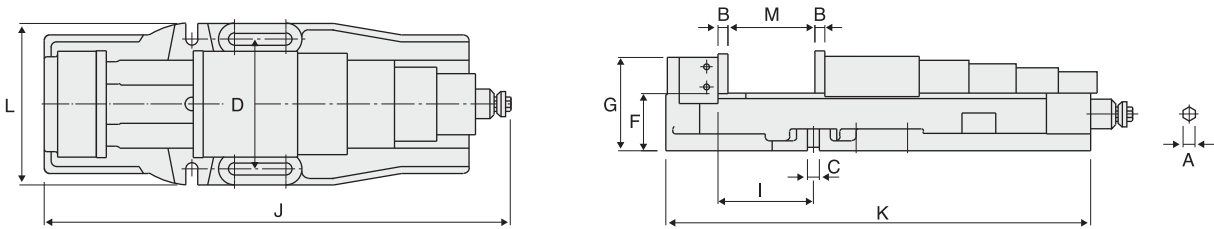

**SPECIFICATIONS** (Material: FCD 60 Ductile Iron. Hardness: HRC 50°)

Unit: mm

NO	Model	A	B	C	D	F	G	I
V-28	HMAV-160	19	15	18	192	85 ± 0.01	140	141 ± 0.01
V-29	HMAV-200	19	18	18	240	97 ± 0.01	160	190 ± 0.01
NO	Model	J	K	L	M	M1	Weight (kg)	
V-28	HMAV-160	740	628	240	0-310	140-450	50	
V-29	HMAV-200	830	720	280	0-395	155-550	95	

**DIMENSIONS**

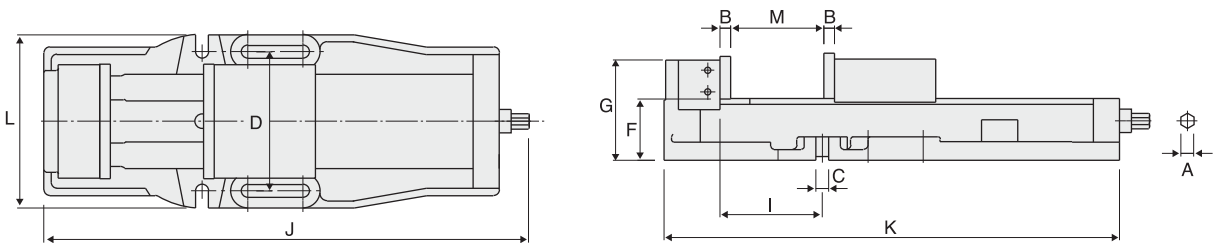

**SPECIFICATIONS** (Material: FCD 60 Ductile Iron. Hardness: HRC 50°)

Unit: mm

NO	Model	A	B	C	D	F	G	I
V-30	HEAV-160	19	15	18	192	85 ± 0.01	140	141 ± 0.01
V-31	HEAV-200	19	18	18	240	100 ± 0.01	160	190 ± 0.01
NO	Model	J	K	L	M	M1	Weight (kg)	
V-30	HEAV-160	683	628	240	0-340	140-480	50	
V-31	HEAV-200	775	720	280	0-425	155-580	95	