



A-05~09

## PRECISION INDEX TABLE

**Model: HPI-300, 450, 600, 800, 1000**

- The "HOMGE" PRECISION INDEXING TABLES are constructed with an AIR CYLINDER between the mating surfaces. This system reduces friction and even when heavy loads are applied to the table. It ensures that manual rotation is almost effortless, and the highest accuracy and repeatability are achieved.
- Rotation is very quick, taking less than 3 seconds to reposition the table.
- HEAVY DUTY CONSTRUCTION is built of (FCD 55) Ductile Iron suitable for heavy cutting.



Curved Coupling Gear is made of **HIGH GRADE BEARING STEEL** which provides rigidity and super high precision.

### STANDARD ACCESSORIES

**Supplied with these tables are:**

- AIR COUPLER for connection to air supply
- 3m RUBBER PIPE
- Set of 4 CLAMPING BLOCKS

### PERMISSIBLE CUTTING FORCE

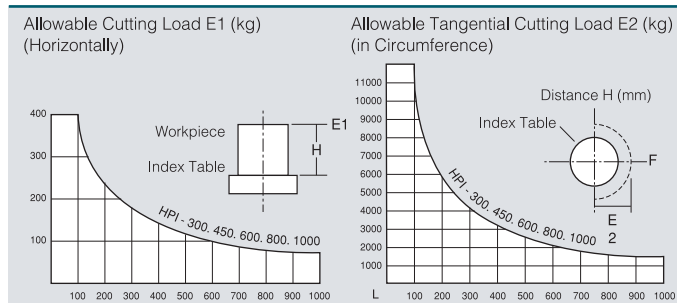

### SPECIFICATIONS

Unit: mm/inch

NO	A-05	A-06	A-07	A-08	A-09
<b>Model</b>	HPI-300	HPI-450	HPI-600	HPI-800	HPI-1000
<b>1 LXW</b>	300x300 (12"x12")	450x450 (18"x18")	600x600 (24"x24")	800x800 (32"x32")	1000x1000 (40"x40")
<b>2 Height</b>	130 (5 1/8")	150 (6")	200 (7 7/8")	280 (11")	300 (12")
<b>3 Spindle hole</b>	25 (1")	30 (1 1/4")	40 (1 1/2")	65 (2 3/8")	60 (2 3/8")
<b>4 T-Slot</b>	14 (9/16")	18 (11/16")	20 (3/4")	22 (7/8")	22 (7/8")
<b>5 Driving</b>	Air Pressure 5~8kgs/cm <sup>2</sup>				
	Longitudinal	Manual			
	Revolving	Manual			
<b>6 Maximum load weight vertically in theory</b>	1200 (2645 lb)	2400 (5921 lb)	3400 (7496 lb)	4500 (9920 lb)	6000 (13225 lb)
<b>7 Allowable load weight (kg)</b>	500 (1102 lb)	1000 (2205 lb)	2000 (4409 lb)	3000 (6614 lb)	5000 (11021 lb)
<b>8 Number of division</b>	Divisors of 24 (2, 3, 4, 6, 8, 12) Divisors of 72 (2, 3, 4, 6, 8, 12, 18, 24, 36, 72) and divisions by integers of 5° angles, custom-made orders for special dividing integers.				
<b>9 Table rotation</b>	clockwise and anticlockwise				
<b>10 Division (second)</b>	divide into 24 or 72 equal parts ± 3				
<b>11 Weight (kg)</b>	90	200	460	900	1200

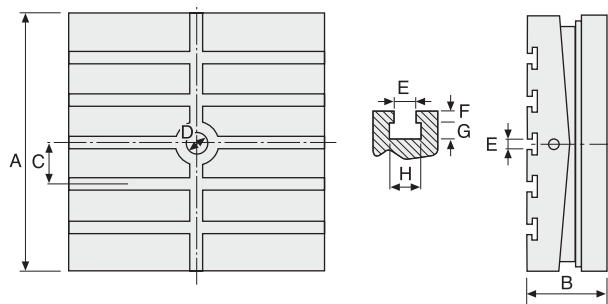

### SPECIFICATIONS (Materia: FCD 55 Ductile Iron)

Unit: mm/inch

NO	A-05	A-06	A-07	A-08	A-09
<b>Model</b>	HPI-300	HPI-450	HPI-600	HPI-800	HPI-1000
<b>Unit</b>	mm inch	mm inch	mm inch	mm inch	mm inch
<b>A</b>	300 12	450 18	600 24	800 31	1000 40
<b>B</b>	130 5 1/8	160 6 15/16	200 7 7/8	280 11	300 12
<b>C</b>	100 4	100 4	100 4	100 4	125 5
<b>D</b>	25 1	30 1 3/16	40 1 1/2	65 2 9/16	60 2 3/8
<b>E</b>	14 9/16	18 1 1/16	20 3/4	22 7/8	22 7/8
<b>F</b>	14 9/16	16 5/8	20 3/4	23 15/16	23 15/16
<b>G</b>	12 15/32	12 15/32	14 9/16	15 19/32	15 19/32
<b>H</b>	25 1	30 1 13/16	34 1 3/8	38 1 1/2	38 1 1/2