

1. The new **Patented PNEUMATIC SYSTEM** is designed to enhance clamping force of 0-8000kg and can be adjusted depending on the material of work-piece.

2. Vice body is made of Ductile Iron above FCD 60 grade for high precision and durability. With a force of 4500kg, the shape will deflect less than **0.01mm**.

3. Vice can be mounted horizontally or vertically.

4. Slide ways are **HARDENED** to **HRC 50°** to further increase durability and maintain positioning height over long use.

5. The **special ANGLE-LOCK SYSTEM** with compact design and high-grade iron of over FCD 60 grade for high rigidity automatically pulls the work-piece down to the accurate position of within **0.01mm** under 4500kg.

6. Tubes are designed with **different colors** for quick repair.

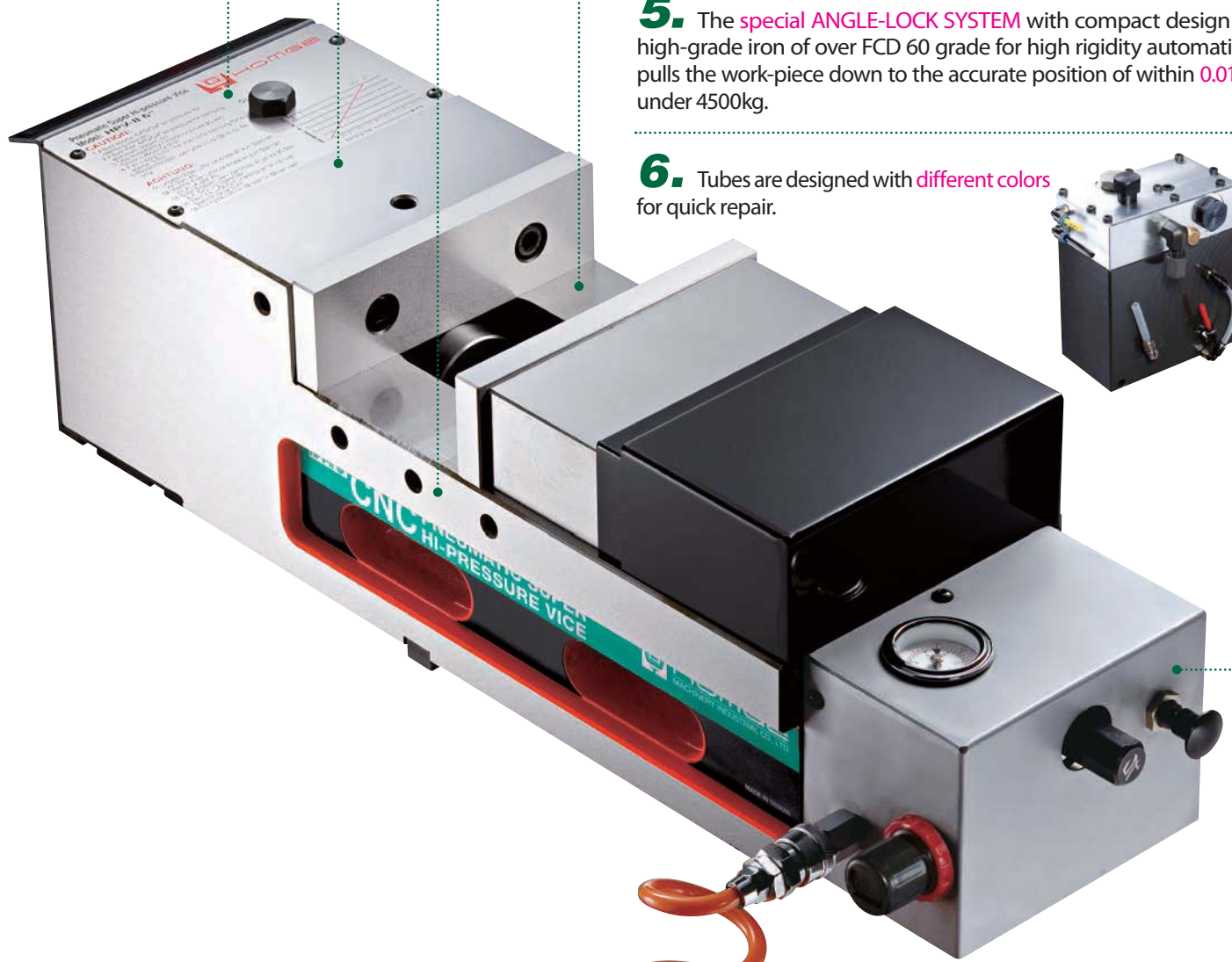

Fixed height so several vices can be used together.

This vice is highly suitable for precision mould making on machining centers as well as heavy duty machining which require high clamping force with high accuracy.

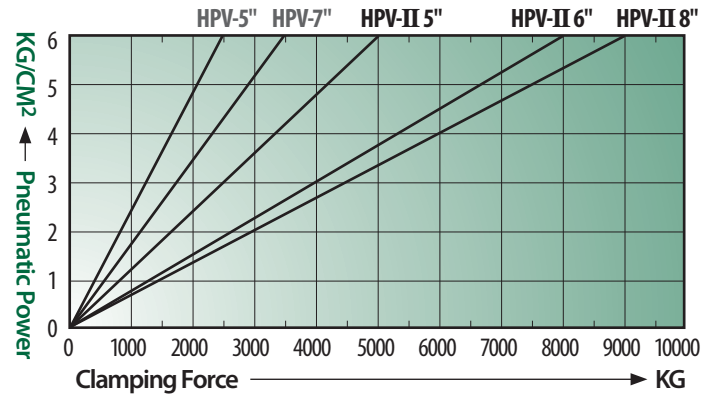
Pneumatic power source 6kg/cm²

DIMENSIONS

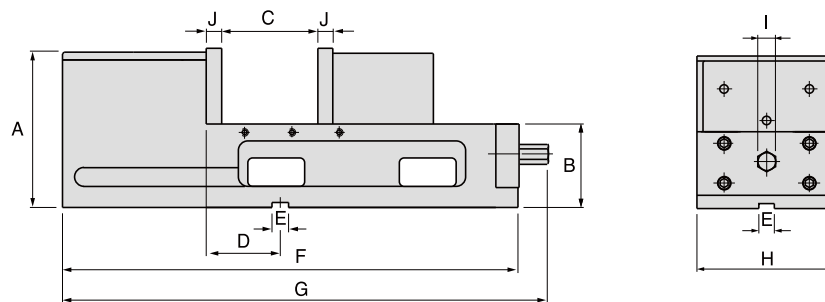

SPECIFICATIONS (Hardness: HRC 45°)

Unit: mm

NO	Model	A	B	C	D	E	F	G	H	I	J	Max. Clamping Force	Safety Range	Weight(kg)
A-01	HPV-5"	165	88±0.01	156	76±0.02	18	480	517	139	19	15	0-2500kg	4mm	42
A-02	HPV-7"	183	115±0.01	185	53±0.02	18	570	610	177	19	18	0-3500kg	4mm	83

DIMENSIONS

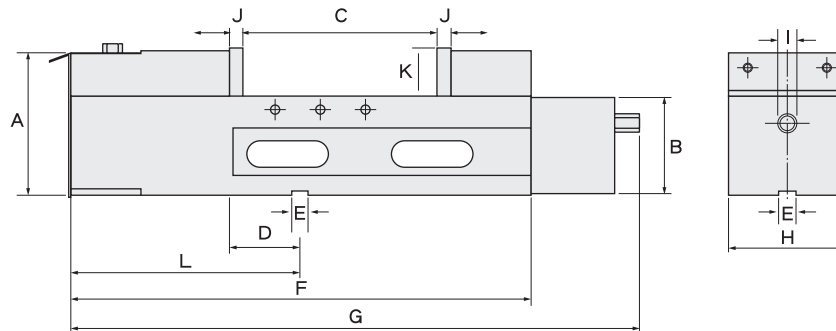

SPECIFICATIONS (Material: FCD 60 Ductile Iron. Hardness: HRC 50°)

Unit: mm

NO	Model	A	B	C	D	E	F	G	H	I
A-03A	HPV-II 5"	158	116±0.01	150	78±0.02	18	456	546	130	19
A-03	HPV-II 6"	163	110±0.01	190	78±0.02	18	497	587	160	19
A-04	HPV II 8"	163	110±0.01	330	107±0.02	18	657	747	200	19
NO	Model	J	K	L	Max. Clamping Force		Safety Range		Weight(kg)	
A-03A	HPV-II 5"	15	45	255	0-5000kg		6mm		42	
A-03	HPV-II 6"	15	53	255	0-8000kg		6mm		55	
A-04	HPV II 8"	18	53	275	0-9000kg		6mm		85	